

Model	For rated loads up to	Car speed range in 2:1	Traction sheaves diameter range	Max Static Load
	[kg]	[m/s]	[mm]	[kN-kg]
SGS8 	1275	0,63 ... 2,00	120(*) , 160(*), 200, 210,240	29,4-3000

With central sheave (for systems with cantilever arches, with gauges guides and reduced headrooms).

* Pu-coated ropes

Hilighted pulley diameter is the one used to calculate max allowed capacity in standard condition (see calculation for each model).

Sample data; for more detailed evaluations we recommend our product configurator.



Rated Torque **245 Nm (S3 40%)**
 Braking Torque **2x280 Nm**
 Power Range (min - max) **1,5 - 7,4 kW**
 Maximum Static Load **29,4 kN - 3000 kg**
 Maximum Weight **138 kg**
 Motor Rated Voltage **360 V - 208 V**



CONFIGURATION EXAMPLES TABLE**

Model	Ø Traction sheave [mm]	Car speed [m/s]	Q Rated load [kg]	P Car weight [kg]	rpm [min ⁻¹]	p *** [kW]	I *** [A]	Installation frequency [Hz]	Ropes Nr x diameter Ø [mm]
SGS8150B	120	0,63	1275	1400	199	4,93	12,5	33,2	6 x Ø 6,5 (*)
SGS8150B	160	0,63	800	950	199	3,12	10,5	25,0	4 x Ø 6,5 (*)
SGS8150B	160	1,00	800	950	254	4,94	12,9	39,6	4 x Ø 6,5 (*)
SGS8150B	200	0,63	630	900	120	2,87	7,9	20,0	7 x Ø 6,5
SGS8150B	200	1,00	630	900	199	4,50	12,0	31,7	7 x Ø 6,5
SGS8150B	210	0,63	630	900	120	2,75	8,1	19,1	7 x Ø 6,5
SGS8150B	210	1,00	630	900	199	4,41	12,21	30,2	7 x Ø 6,5
SGS8150B	210	1,60	480	700	291	5,64	13,5	48,5	6 x Ø 6,5
SGS8150B	240	0,63	480	700	120	2,13	7,2	16,6	5 x Ø 6,5
SGS8150B	240	1,00	480	700	199	3,54	11,2	26,6	6 x Ø 6,5
SGS8150B	240	1,60	480	700	291	5,67	13,7	42,4	6 x Ø 6,5

Configurations specifications

Harmonized standards of reference	EN 81-20 e EN 81-50
Roping - Wrapping type	2:1 - Conventional Single Wrap
Machine position	Top
Compartment efficiency	0,9
Nr of deflection pulleys on ball bearings	2 for rated load ≤ 1000 kg 3 for rated load > 1000 kg
Counterweight balancing	50%
Travel height	30 m
Duty cycle	S3 40%
Starts/hour	180
Wrapping angle	180°
Acceleration	0,1m/s ² for car speed ≤ 0,15 m/s 0,3±0,5m/s ² for car speed ≤ 1 m/s 0,5±0,7m/s ² for car speed > 1 m/s

Refer to the product configurator for the value of the short circuit torque, the relative speed and the minimum voltage that allows the operation of gearless machine.

* Pu-coated ropes

** Sample data; for more detailed evaluations we recommend our product configurator.

*** Values referred to configuration table (360V)

SGS8 - DIMENSIONS

Mod. SGS8150B

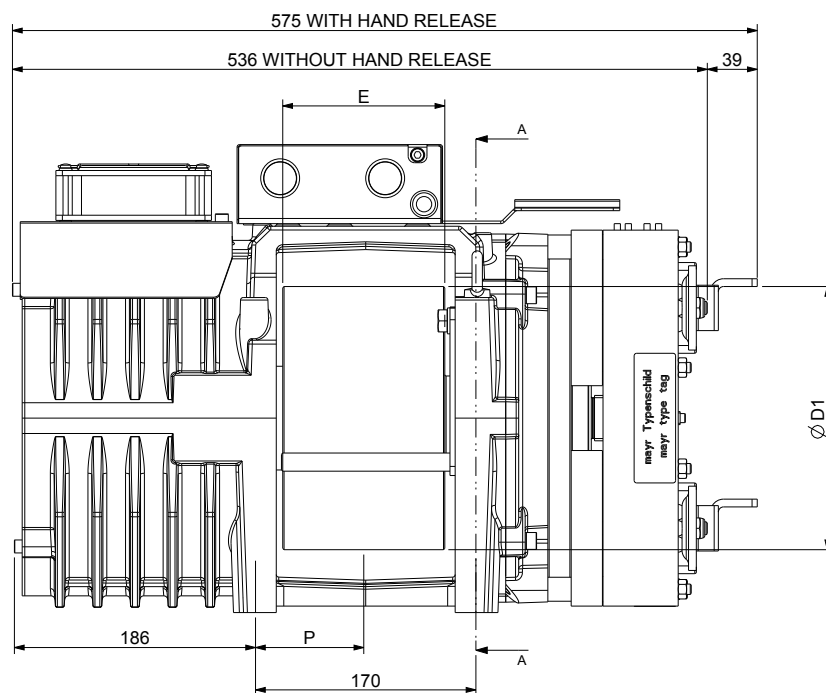
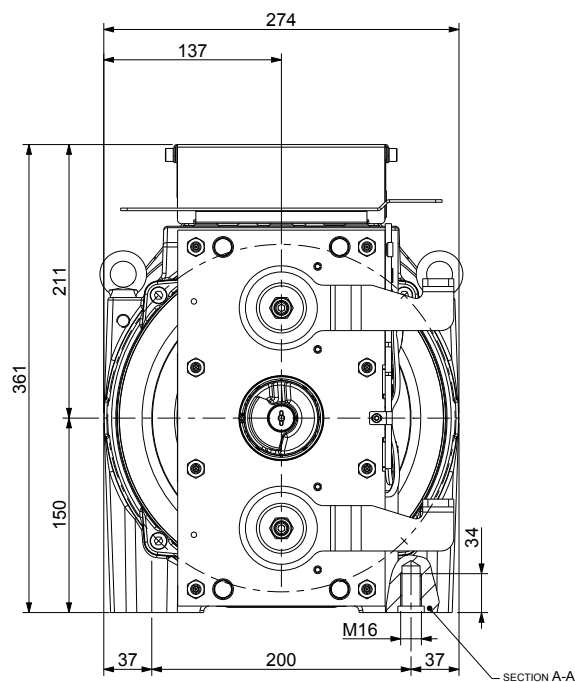

Ø D1	E	P	Max Weight	Inertia	Roping System	Torque S3 40%	Max Static Load	Max Power **
[mm]	[mm]	[mm]	[kg]	[kgm ²]		[Nm]	[kN - kg]	[kW]
120	90	66	138	0,10	CSW*	245	29,4 - 3000	7,4
160	125	85		0,14				
200				0,19				
210				0,22				
240				0,28				

Brake Specifications

Braking Torque: 2x280 [Nm]
 Standard Supply Voltage: 207 [V DC]
 Power: 2x79 [W]
 Degree of Protection: IP10

Standard Encoder Data

Type: Absolute EnDat
 Model: Heidenhain ECN 1313
 Positions values/rev: 2048 imp 13 bits
 Degree of Protection: IP40
 Standard Cable Length: 10 [m]

Ventilation data

Voltage: 230 [V]
 Power: 1x16 [W]

* CSW: Conventional single wrap.

** Sample data; for more detailed evaluations we recommend our product configurator.



by
SICOR ITALY
AN  ELEVANTIS COMPANY

Sicor Italy S.R.L.

Viale Caproni, 32 Rovereto (TN) - Italy · Tel: +39 0464 484 111 · info@sicoritaly.com

www.sicoritaly.com